

# Copper Press Reducing Coupler (M-Profile)

## MCP 04



### Technical Data

- Working Pressure 16 Bar @ 95°C
- "M" profile press jaws or slings
- Approved tools include Novapress, REMS, Rothenberger and Ridgid

### Applicable Standards

- WRAS approved
- For use with type TX copper tubing conformant to EN 1057
- Manufactured to EN1254 standard

### Features & Benefits

- Durable and secure leak proof joint
- Braze free, permanent joint - no hot works required
- Huge time and resource savings
- 25 Year warranty
- Blue plastic film which will fall off when crimped for easy identification of pressed joint
- 2 point press
- Dust Covers

### Material Specifications

NO	Description	Materials
1	Body	Cu-DHP (CW024A)
2	Crimp indicator film	PVC, Blue
3	O-Ring	EPDM
4	Dust Cap	PE

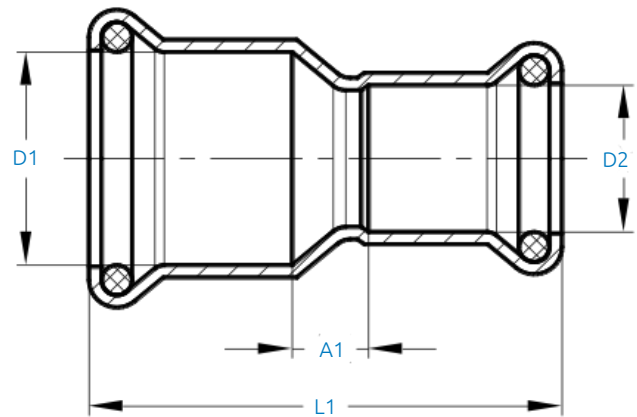

### Product Codes and Dimensions

STOCK NO.	D1	D2	L1	A1
27900	22	15	50	8.5
27901	28	15	55	12
27902	28	22	52	8
27903	35	22	61	14
27904	35	28	60	10
27905	42	22	70	19
27906	42	28	67.5	14.5
27907	42	35	68	10.5
27908	54	28	81	23
27909	54	35	81	19
27910	54	42	81	14