

Copper Press GAS Equal Tee (M-Profile) MGP 30



Technical Data

- Max Working Pressure 5 Bar (External) / 1 Bar (Internal) @ 70°C
- "M" profile press jaws or slings
- Approved tools include Novapress, REMS, Rothenberger and Ridgid
- Suitable for above ground 2nd and 3rd family gases to EN437

Applicable Standards

- For use with type TX copper tubing conformant to EN 1057



Features & Benefits

- Durable and secure leak proof joint
- Braze free, permanent joint - no hot works required
- Huge time and resource savings
- 25 Year warranty
- Yellow plastic film which will fall off when crimped for easy identification of pressed joint
- 2 point press
- Dust covers keep O-ring clean prior to assembly

Material Specifications

NO	Description	Materials
1	Body	Cu-DHP (CW024A)
2	Crimp indicator film	PVC, Ochre Yellow
3	O-Ring	HNBR
4	Dust Cap	PE

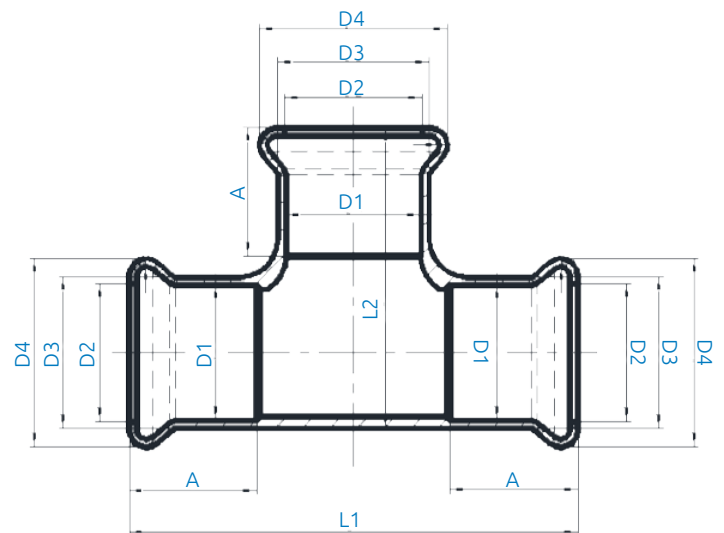

Product Codes and Dimensions

STOCK NO.	D1 (mm)	D2 (mm)	D3 (mm)	D4 (mm)	A (mm)	L1 (mm)	L2 (mm)
29636	15	15.6	18	23	19	64	41
29637	22	22.8	25	31.3	20	74	49.5
29638	28	28.8	31	37.4	22	84	57
29639	35	35.7	38.3	44.7	25	100	69
29640	42	42.8	45.3	53.5	29	116	86
29641	54	54.8	57.3	65.3	34	139	98
29642	67	69.1	71.7	82.6	48	189	133
29643	76	78.6	81.1	94.4	49	208	139.5
29644	108	110.9	113.8	132.1	65	273	196